

THIS DRAWING AND ALL INFORMATION ON IT IS THE PROPERTY OF JACOBY-TARBOX, DIVISION OF THE CLARK-RELANCE CORPORATION. IT IS CONFIDENTIAL AND IS GIVEN TO YOU FOR A LIMITED TIME ONLY. YOU MUST BE REGISTERED WITH THE CLARK-RELANCE CORPORATION AND THE CLARK-RELANCE CORPORATION MUST BE NOTIFIED IN WRITING OF ANY REVISIONS TO THIS DRAWING AND THE PARTS THEREON. NO PHOTODUPLICATIONS OR REPRODUCTIONS OF ANY KIND ARE TO BE MADE WITHOUT THE WRITTEN CONSENT OF THE CLARK-RELANCE CORPORATION.

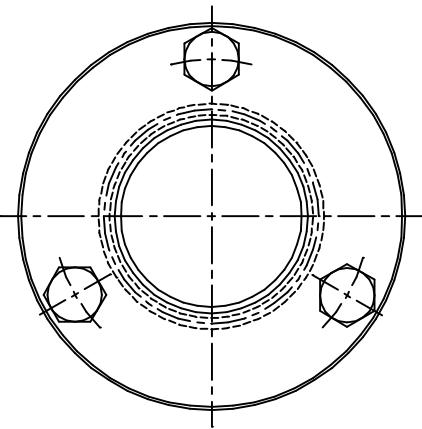

USDA DAIRY ACCEPTED

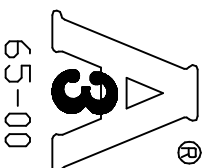

65-00

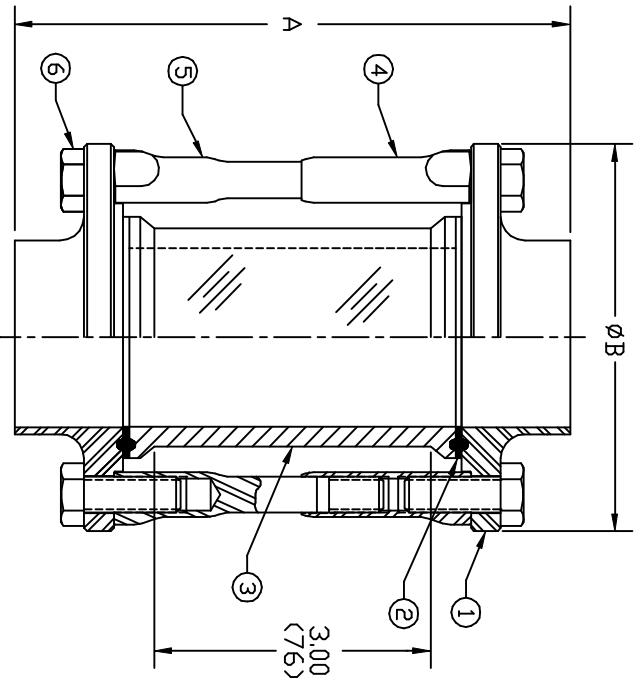

ITEM	NAME	QTY.	MATERIAL
1	HEAD	2	
2	SANITARY GASKET	2	
3	OPTICAL CYLINDER	1	BORO
4	UPPER SPACER	3	304 SS
5	LOWER SPACER	3	304 SS
6	BOLT	6	304 SS

SPECIFICATIONS

Materials:

Heads: 304 SS, 316L SS to ASTM A276
Window: Annealed Borosilicate Glass
:Acrylic (Optional)
Gaskets: Standard 3A Sanitary Gaskets
Fasteners: 304 SS
Surface Finish:

Internal:
32 Ra (150 Grit, .8 micrometers) Standard
(Finer finishes, and/or electropolishing
available upon request.)
External:

32 Ra (150 Grit, .8 micrometers) Standard
Optional Features
Special lengths available up to 48 inches ("A" Dim)
Pressure ratings decrease with additional length
Model: 7000-WL

*SIZE	INCHES A (mm)	INCHES B (mm)	PRESSURE (MAX)
1/2-3/4	6.25 (159)	3.75 (95)	150 PSIG
1	5.75 (146)	3.75 (95)	150 PSIG
1 1/2	5.75 (146)	3.75 (95)	150 PSIG
2	5.75 (146)	4.00 (102)	150 PSIG
2 1/2	6.38 (162)	4.75 (121)	150 PSIG
3	6.50 (165)	5.50 (140)	150 PSIG
4	7.25 (184)	6.88 (175)	150 PSIG

* SIZES ARE STANDARD TUBE O.D.'S
IN INCHES